

Maki

WIRELESS
4G



Your
Imagination
is your only
limitation

OUTSTANDING LOOKS

Maki's architectural design, combining elegance and simplicity in a compact form factor, will easily fit any home and office environment. Always on, in style.

EASY SETUP

Get connected in 60 seconds. Power-up Maki and get all your devices online. Any doubt? Maki's high contrast LCD screen will explain it all, step by step.

BREAKTHROUGH APPS

Maki was designed to unleash the potential of the web and its popular applications in an unprecedented way, making it the first 4G plug to the Cloud.

WIRELESS BONANZA

With a state of the art 802.11n Wifi access point, Maki is the perfect hub for a wide range of connected devices, providing seamless and effortless connectivity.

BLAZING PERFS

Maki features a best in class link budget on its 4G Wan interface combined with a high performance CPU resulting in a truly dynamic and stunning user experience.

FULLY CUSTOMIZABLE

From its hardware architecture to its open source software stack, Maki is extensively configurable to fit all needs, end to end.

A CPE MADE BY OPERATORS FOR OPERATORS



Radically Different

Maki is the first 4G CPE to have been entirely designed and developed by operators, for operators. As such, it was engineered to tackle all the challenges wireless broadband operators need to face in order to address their customers.



Reduce operating expenses, contain churn and increase ARPU

Why Maki? Maki is a project developed by Bolloré telecom, a global mobile broadband operator with operations in France and Western Africa.

We created Maki because we believe innovation is not only a driver in our industry, but a vital necessity. Maki is our response to the lack of innovation in the fixed wireless broadband ecosystem. We wanted Maki because we endeavor to leverage the web as a revenue driver but also because we want the internet experience to be as simple for customers as it is for us. And who could better understand the needs of a broadband wireless player than an operator itself?

Entirely developed in-house by a telecom operator, Maki and its software suite were designed taking into consideration the challenges wireless broadband operators have to face in a competitive, service-driven telecom environment.

State of the art radio interfaces. Maki was engineered to provide the best possible link budget in order to minimize the network OPEX spendings for indoor coverage, solving an equation where every dB matters.

Full remote control. As an operator it is important to have full control over the devices on your network, from provisioning to upgrade management as well customer support. Maki is 100% managed over the air, safely and with standard OMA-DM and TR-069 protocols.

Endless applications. As a fully-fledged service platform, Maki goes beyond traditional Internet access device features, delivering a number of online services straight to the customer, to the benefit of both loyalty and ARPU.

Fully customizable to meet your needs



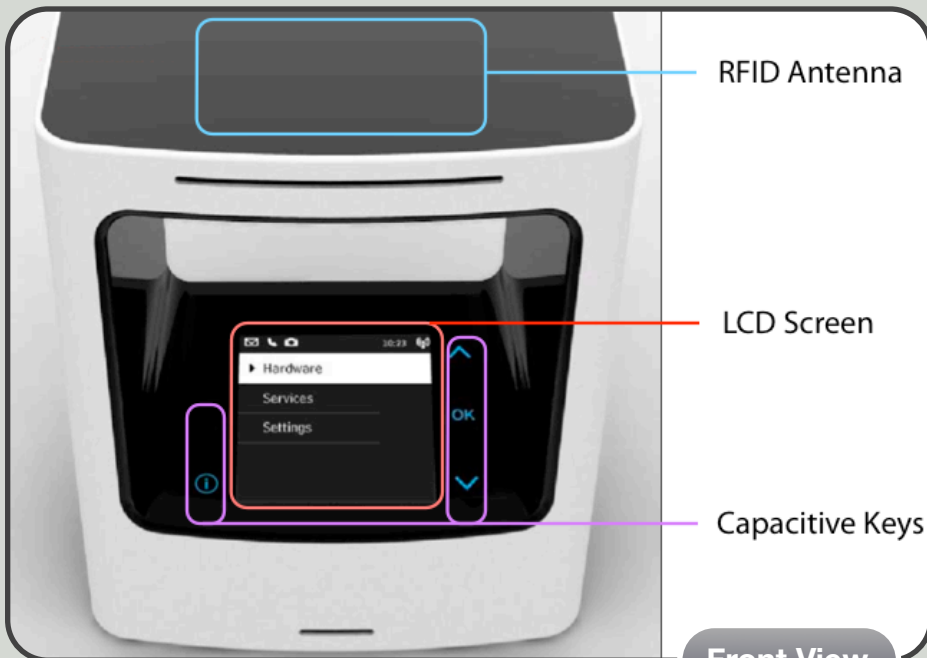

Front View

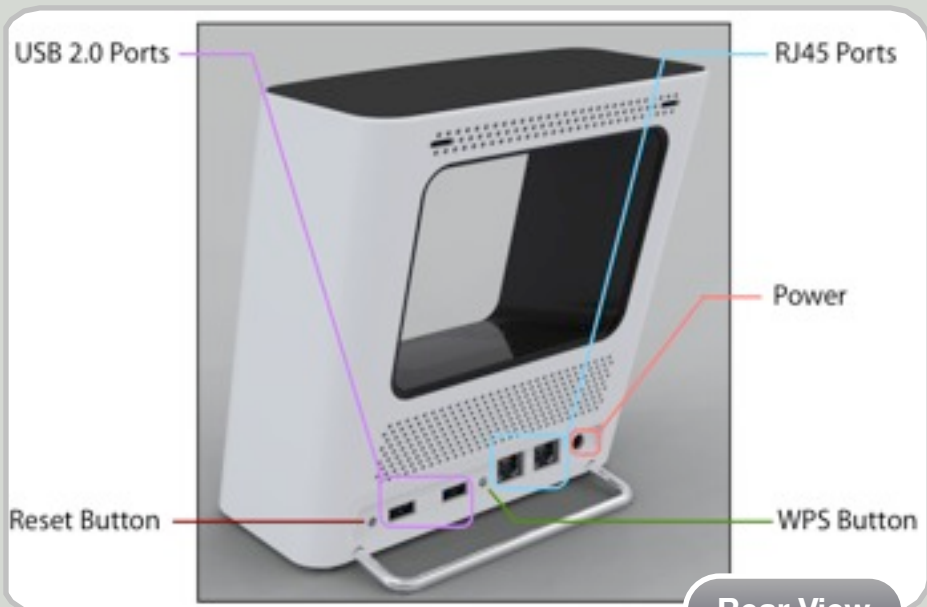

Rear View

Easy to install. Maki is also easy to use. with carefully studied ergonomics, plugging the ecosystem of connected devices to the Cloud has never been so straightforward.

Featuring a powerful 802.16e MIMO interface for WAN connectivity and a state of the art 802.11n Wifi access point, Maki is the perfect hub for a wide range of connected devices, from netbooks to smartphones, but also media streaming equipment, printers, cordless phones and even home automation solutions.



LCD Screen. Maki's built-in high contrast LCD screen will only reveal itself when necessary. Whether you require assistance or need to interact with Maki, all you need to know will be clearly displayed.



802.11n. Faster data rates and full compatibility.

Featuring three antennas for MIMO, Maki also makes the most of WPS (Wifi Protected Setup) letting you setup your home network by simply pressing a button.



USB 2.0. Featuring two USB ports, Maki can be connected to and interact with virtually any USB appliance on the market.



SD HC Reader. Uploading your holiday pictures has never been easier; insert your SD card in the slot and your pictures are securely available to share with your family and friends.



RFID Interface. Maki features an RFID card reader which makes it easy to identify users and deliver content tuned specifically to a given user. Safe identification, without the hassle of passwords.

TECH SPECS

Air Interfaces

- WiMAX: 802.16e 2x2 MIMO @ 26 dBm
- Wifi: 802.11 b/g/n Access Point - Router

System

- Hardware: Freescale MPC8313 SoC (333 MHz)
128 MB DDR2-SDRAM
8 MB NOR Flash
128 MB NAND Flash
- Software: Linux 2.6 Kernel
Public SDK (OpenEmbedded based)
Highly customizable UI (XML + Javascript)

Interfaces

- User: 128 x 128 LCD Screen
5 Capacitive sensor keys
- Radio: RFID dual side reader (card slot + top area)
- Network: 2 RJ45 Fast Ethernet Ports
- Ports: 2 USB 2.0 Ports
1 SD Card Slot

GREAT APPS FOR EVERYTHING

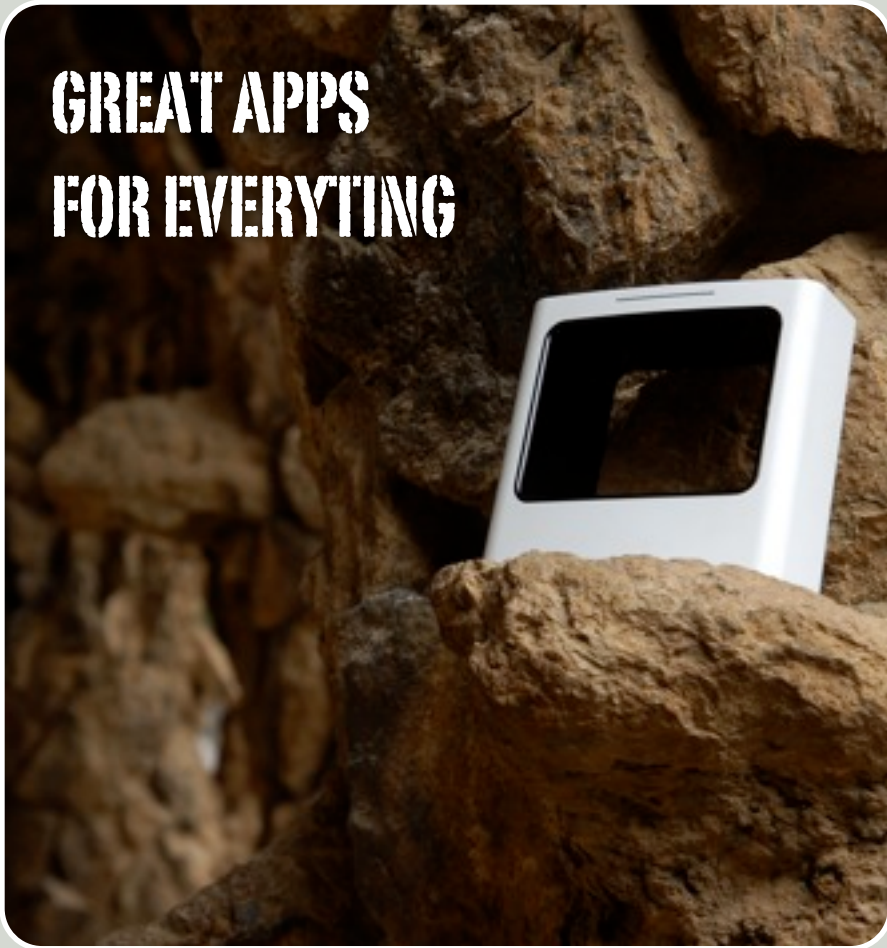

Open Source Software

Maki's software stack is **fully open source**, meaning there are no hidden software licensing costs. It's all inclusive. So much so that Maki is the only CPE on the market that ships with its own open-source OMA-DM server!



Welcome to Maki, a revolutionary concept in the wireless broadband world !

Devised with a strong focus on simplicity and ergonomics, Maki aims at drastically streamlining the wireless broadband experience and fostering the adoption of web services and applications. In a competitive, service-driven environment, operators need to differentiate with innovative, loyalty increasing services.

Maki is a breakthrough versatile service platform opening endless possibilities in the development of applications and services.

Ecosystem. Maki's open source software stack has been developed with both flexibility and robustness in mind. Based on open standards, Maki is web-centric in its core and already interacts with many popular web services and applications. And the Cloud is the limit!

Versatility out of this world

On Air. Get push notifications any time through Maki. Be notified of your Twitter updates without even turning on your computer!

Fire & Forget. Plug your digital camera to Maki and you are one button press away from sharing your pictures on Picasa. Maki does it all: transfer, resize, upload and share on the cloud. No additional software required, and it is all done in the background.

One More Thing... Maki comes with an extensive carrier-grade open source management software suite. For free.

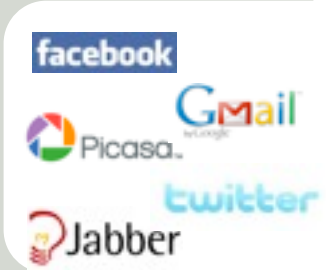

<p>MEET SASHIMI, THE MAKI SOFTWARE SUITE</p>	<p>LYCHEE</p> 	<p>CARAMBOLA</p> 
	<p>The front-end Configure all of Maki's services from a flexible one-stop shop.</p>	<p>The OMA-DM Server Manage Maki's provisioning through carrier grade standards, also features OMA Data Synchronization!</p>

All companies' names, products, services may be the properties of their respective owners.